

# 648 492 AN/ALQ-71(V)-3 ECM pod

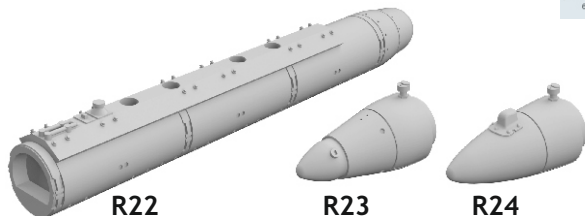

1/48 scale

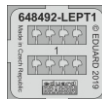
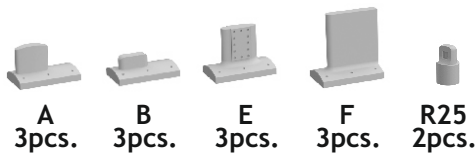

# 648 492 AN/ALQ-71(V)-3 ECM pod 1/48

BRASSIN

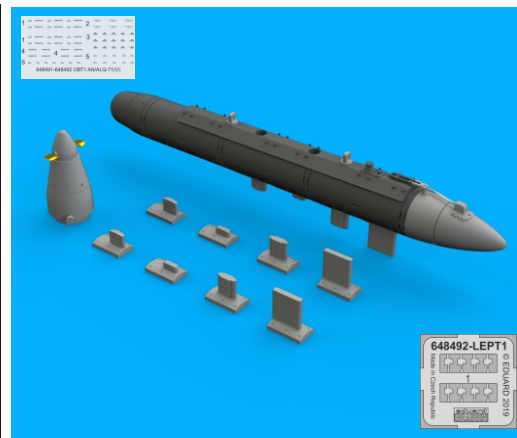

BRASSIN

## COLOURS

GSI Creos (GUNZE)		Mr.SUPER METALIC	
AQUEOUS	Mr.COLOR		
<a href="#">H 8</a>	<a href="#">C 8</a>	SILVER	
<a href="#">H28</a>	<a href="#">C78</a>	METAL BLACK	
<a href="#">H316</a>	<a href="#">C316</a>	WHITE	
<a href="#">H318</a>	<a href="#">C318</a>	RADOME	
			SUPER IRON 2

This product contains metal and resin detail parts for upgrading scale plastic models. When selecting this set make sure that it is for the kit mentioned in product name as these sets are made specifically for that kit. When upgrading the model some cutting or corrections may be necessary for parts to fit accurately. **WARNING!** This set contains small and sharp parts. Work carefully in a ventilated and well-lit room. Safety glasses are recommended. This product is not suitable for children below 14 years of age.

Tento výrobek obsahuje leptané a odlévané detaily pro úpravu a vylepšení plastického modelu. Při výběru sady kovových detailů zkontrolujte, zda je určena pro model, který chcete upravit. Model, pro který je sada určena, je uveden u názvu výrobku. Pro přesnou aplikaci kovových a odlávaných dílů může být zapotřebí upravit díly upraveného modelu. **POZOR!** Sada obsahuje malé ostré díly. Pracujte ve větrané a dobře osvětlené místnosti. Doporučujeme použití ochranných brýlí. Tento výrobek není vhodný pro děti mladší 14 let.



www.eduard.com  
10,95

435 21 Obrnice 170  
Czech Republic



## AN/ALQ-71(V)-3 ECM pod

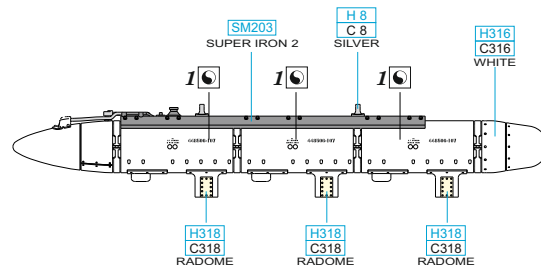

**BEST BRASS RESIN AROUND!**

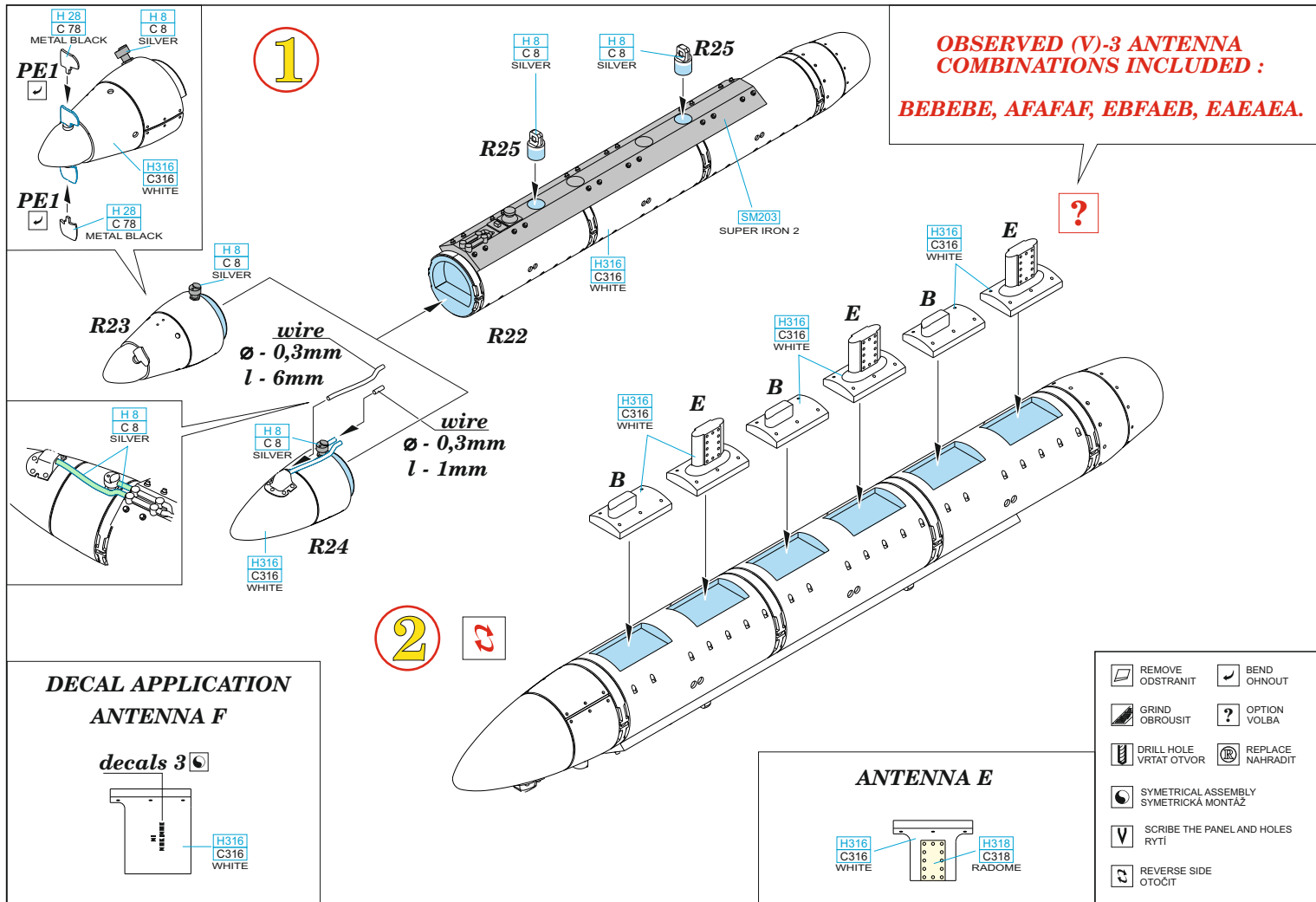

1

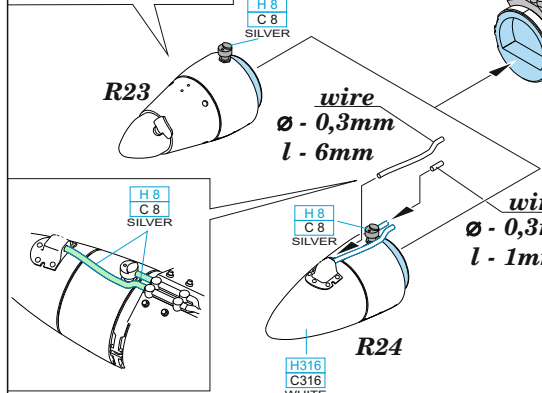
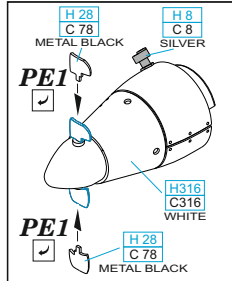

**OBSERVED (V)-3 ANTENNA COMBINATIONS INCLUDED :**  
**BEBEBE, AFAFAF, EBFAEB, EAEAEA.**

?

2

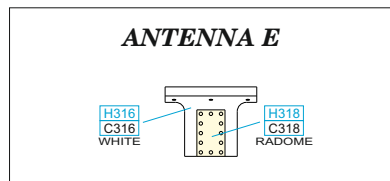
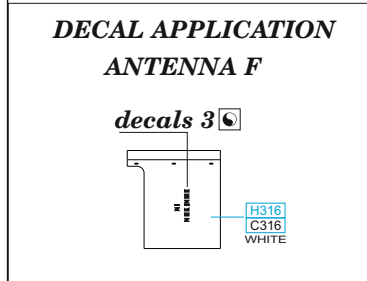

- REMOVE  
ODSTRANIT
- GRIND  
OBROUSIT
- DRILL HOLE  
VRTAT OTVOR
- SYMMETRICAL ASSEMBLY  
SYMETRICKA MONTAZ
- SCRIBE THE PANEL AND HOLES  
RYTI
- REVERSE SIDE  
OTOČIT
- BEND  
OHNOUT
- OPTION  
VOLBA
- REPLACE  
NAHRADIT